

AVVOLGITUBO IDRAULICI

HYDRAULIC HOSE REELS

ENROULEURS HYDRAULIQUES

SCHLAUCHTROMMELN

ENROLLADORES HIDRÁULICOS DE MANGUERAS

БАРАБАНЫ ДЛЯ ГИДРАВЛИЧЕСКИХ ШЛАНГОВ

HORTUM TAMBURLAR

بكرات للخرطوم الهيدروليكية



10



## AVVOLGITUBO IDRAULICI - AVVOLGITUBO IDRAULICI

La gamma di **Avvolgitubo Idraulici Ferrari** è caratterizzata da modelli con ingombri ridotti, grazie ad un contenuto diametro esterno, e dall'innovativo fissaggio dei tubi idraulici termoplastici.

*Ferrari's Hydraulic Hose Reels range features models with compact dimensions, thanks to a small outer diameter, and an innovative locking system for thermoplastic hydraulic hoses.*

La nostra gamma di **Avvolgitubo Idraulici serie FT** offre modelli che vanno dalle **due vie** alle **cinque vie**, disponibili **sia con attacco radiale** che **frontale**.

*Our Hydraulic Hose Reel FT series consists of models ranging from two-ways to five-ways hose reels, available with frontal or radial attachment.*

Il corpo rotante è realizzato in **ghisa GS 500** e alloggiato su un albero in acciaio superficialmente temprato; il riavvolgimento del tubo avviene grazie ad una molla di richiamo montata in una sede protetta.

*The rotating body is made of GS 500 cast iron and positioned on a surface-quenched steel shaft; a recall spring seated in a protected location allows for the hoses' rewind.*



**Attacco radiale**  
*Radial attachment.*



**Attacco frontale**  
*Frontal attachment.*

**Corpo in ghisa**  
*Cast iron body*

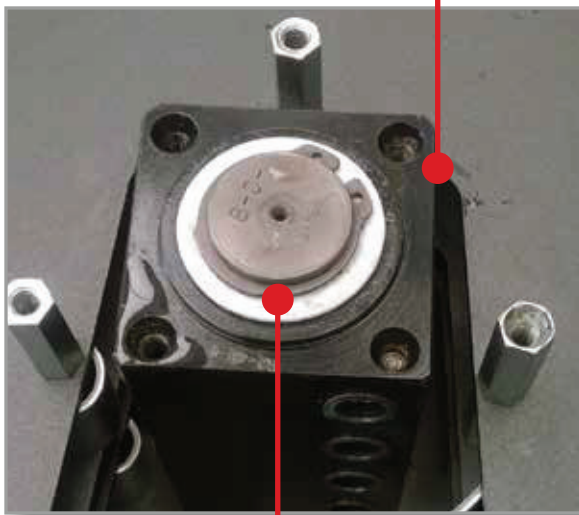

**Albero in acciaio temprato**  
*Quenched steel shaft*



**Molla di richiamo in sede protetta**  
*Protected recall spring*



I **tubi Ferrari** che vengono montati sugli **avvolgitubo serie FT** sono realizzati in fibra sintetica ad alta resistenza e poliuretano antiabrasione. A seconda del modello di avvolgitubo è possibile montare tubi di diametro da ¼" a 1" con **classe di resistenza SAE 100 R7 o R8**, in accordo con la normativa **DIN 20022**. Per il modello di avvolgitubo scelto è necessario abbinare il tubo corretto in base alla pressione di utilizzo; i tubi standard R7 supportano una pressione massima di 200 bar, per pressioni fino a 300 bar è necessario scegliere tubi R8. Sui modelli in cui è previsto il montaggio di tubi binati, l'accoppiamento è realizzato mediante la saldatura dei tubi stessi per migliorarne lo scorrimento.

**Ferrari hydraulic hoses mounted on our Hose Reel FT series** are made with high-resistance synthetic fibers and anti-abrasion polyurethane. Depending on the hose reel model, one can mount hoses with diameters ranging from ¼" to 1" with **SAE 100 R7 or R8 resistance class**, according to **DIN 20022 norm**. For the chosen hose reel model it's necessary to pair the correct hose according to the required work pressure; standard R7 hoses can withstand a maximum pressure of 200 bar, while hoses class R8 can withstand a maximum working pressure of 300 bar. For those models designed for twin-hoses mounting, the coupling is realized through the welding of the hoses to grant a better sliding.

Gli **Avvolgitubo Idrraulici Ferrari serie FT** sono progettati in modo da semplificare in caso di necessità l'inversione del senso di rotazione, e pensati per offrire una lunga durata nel tempo e protezione da urti e collisioni. Sono particolarmente adatti in applicazioni di sollevamento, come per carrelli elevatori, piattaforme aeree o gru da camion.

**Ferrari Hydraulic Hose Reel FT Series** is designed to simplify the change of direction of rotation, if needed, and to grant a long-lasting utilization and protection from bumps and collisions. They are particularly suitable for lifting applications, such as for forklifts, aerial platforms or truck cranes.

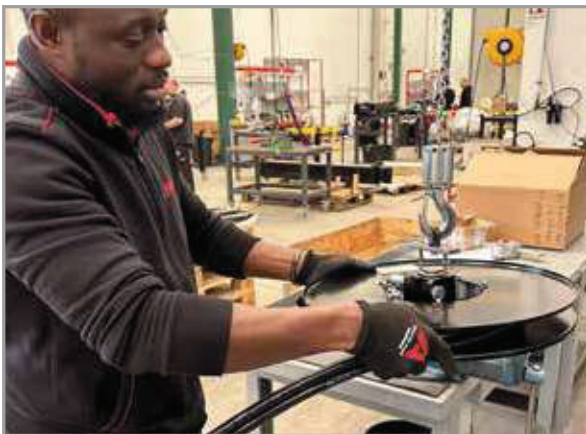

### Linea di produzione Avvolgitubo Ferrari / Ferrari Hose Reels production line

#### CARATTERISTICHE GENERALI AVVOLGITUBO \ HYDRAULIC HOSE REELS GENERAL CHARACTERISTICS

Portata massima (Max flow rate)	1/4"	25 l/min
	3/8"	30 l/min
	1/2"	40 l/min
Pressione max. statica (Max. static pressure)	400 bar	
Pressione max. dinamica (Max. dynamic pressure)	350 bar	
Temperatura funzionamento (Work temperatures)	-20°C / +80°C	
Tratto Tubo Rimanente all'interno del corpo (circa) Length of the Hose Remaining Inside the body (usually)	da 400 mm fino a 1000 mm (from 400 mm up to 1000 mm)	



## AVVOLGITUBI IDRAULICI A 2 VIE CON ATTACCO FRONTALE DEI TUBI 2 WAY HYDRAULIC HOSE REELS WITH FRONTAL ATTACHMENT

In conformità EN 2006/42/CE  
According to EN 2006 42 EC

### FT 100/A F EYE

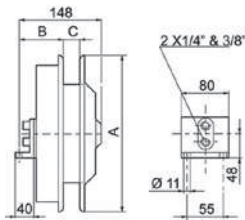

	Ø 1/4"	Ø 1/2"	Ø 3/8"
C	27		36

Modello Model	A Ø mm	B mm	Lungh. max avvolg. (mm) e connessioni Max reel length (mm) and connections			Peso Weight kg
			Ø 1/4"	Ø 1/2"	Ø 3/8"	
FT 100/A200 2V F EYE	200	65	1500			6(1/4")
FT 100/A235 2V F EYE	235	65	2000			6(1/4")
FT 100/A270 2V F EYE	270	65	2500		1800	9(1/4") 9,5(3/8")
FT 100/A300 2V F EYE	300	65	4000		2700	9,5(1/4") 10,5(3/8")
FT 100/A325 2V F EYE	325	65	5000		3500	11(1/4") 12(3/8")
FT 100/A340 2V F EYE	340	65	5200		4000	12,5(1/4") 16(3/8")
FT 100/A385 2V F EYE	385	65	7000		5500	12(1/4") 15(3/8")

Per tubi con raccordo ad occhio e rondelle "bonded-seals"  
For hoses with eye-fitting and "bonded-seals" washers

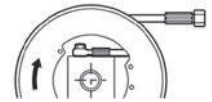

### FT 110/A 2V F

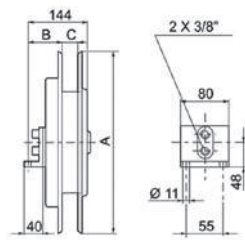

	Ø 1/4"	Ø 1/2"	Ø 3/8"
C	27		36

Modello Model	A Ø mm	B mm	Lungh. max avvolg. (mm) e connessioni Max reel length (mm) and connections			Peso Weight kg
			Ø 1/4"	Ø 1/2"	Ø 3/8"	
FT 110/A325 2V F	325	70	4000		3000	11
FT 110/A370 2V F	370	70	5500		4500	12
FT 110/A385 2V F	385	70	6000		5000	13
FT 110/A400 2V F	400	70	7200		5500	13,5
FT 110/A420 2V F	420	70	8400		6500	14
FT 110/A470 2V F	470	70	11000		8000	15
FT 110/A340 2V F	340	70	4500		3500	11,7

### FT 120/A 2V F

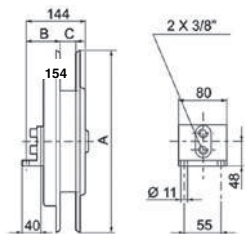

	Ø 1/4"	Ø 1/2"	Ø 3/8"
C	27		36

Modello Model	A Ø mm	B mm	Lungh. max avvolg. (mm) e connessioni Max reel length (mm) and connections			Peso Weight kg
			Ø 1/4"	Ø 1/2"	Ø 3/8"	
FT 120/A470 2V F	470	80	11000		8000	23
FT 120/A500 2V F	500	80	12500		10000	24
FT 120/A520 2V F	520	80	14000		10500	24,2
FT 120/A530 2V F	530	80	14500		11000	24,5
FT 120/A560 2V F	560	80	16000		12500	25,5
FT 120/A625 2V F	625	80	21500		16000	30
FT 120/A650 2V F	650	80	23500		18000	30
FT 120/A715 2V F	715	80			22000	39
FT 120/A790 2V F	790	80			27000	40



## AVVOLGITUBI IDRAULICI A 2 VIE CON ATTACCO RADIALE DEI TUBI 2 WAY HYDRAULIC HOSE REELS WITH RADIAL ATTACHMENT

In conformità EN 2006/42/CE  
According to EN 2006 42 EC

### FT 130/A 2V R EYE

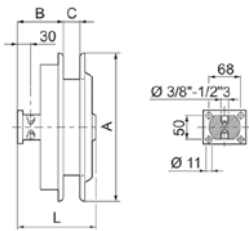

	Ø 1/4"	Ø 1/2"	Ø 3/8"
C	27		36
L	152		160

Modello Model	A B		Lungh. max avvolg. (mm) e connessioni Max reel length (mm) and connections			Peso Weight
	Ø mm	mm	Ø 1/4"	Ø 1/2"	Ø 3/8"	kg
FT 130/A200 2V R EYE	200	65	1500			6(1/4")
FT 130/A235 2V R EYE	235	65	2000			6(1/4")
FT 130/A270 2V R EYE	270	65	2500		1800	9,5(1/4") 10(3/8")
FT 130/A300 2V R EYE	300	65	4000		2700	10(1/4") 11(3/8")
FT 130/A325 2V R EYE	325	65	5000		3500	11,5(1/4") 12,5(3/8")
FT 130/A340 2V R EYE	340	65	5200		4000	12,5(1/4") 16(3/8")
FT 130/A385 2V R EYE	385	65	7000		5500	12,5(1/4") 15,5(3/8")

Per tubi con raccordo ad occhio e rondelle "bonded-seals"  
For hoses with eye-fitting and "bonded-seals" washers

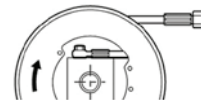

### FT 140/A 2V R

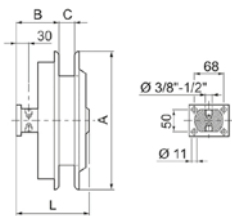

	Ø 1/4"	Ø 1/2"	Ø 3/8"
C	27	46	36
L	167	181	167

Modello Model	A B		Lungh. max avvolg. (mm) e connessioni Max reel length (mm) and connections			Peso Weight
	Ø mm	mm	Ø 1/4"	Ø 1/2"	Ø 3/8"	kg
FT 140/A325 2V R	325	84	4000	2500	3000	11
FT 140/A340 2V R	340	84	4500	3000	3500	11,7
FT 140/A370 2V R	370	84	5500	3300	4500	12
FT 140/A385 2V R	385	84	6000	3500	5000	13,5
FT 140/A400 2V R	400	84	7200	4500	6000	14
FT 140/A420 2V R	420	84	8400	5500	6500	14,5
FT 140/A470 2V R	470	84	11000	6500	8000	16

### FT 150/A 2V R

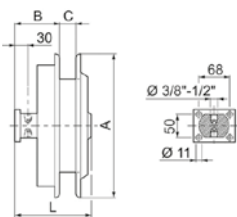

	Ø 1/4"	Ø 1/2"	Ø 3/8"
C	27	46	36
L	182	177	177

Modello Model	A B		Lungh. max avvolg. (mm) e connessioni Max reel length (mm) and connections			Peso Weight
	Ø mm	mm	Ø 1/4"	Ø 1/2"	Ø 3/8"	kg
FT 150/A470 2V R	470	97	11000	6500	8000	23,5
FT 150/A500 2V R	500	84	12500	8000	10000	24
FT 150/A520 2V R	520	97	14000	8500	10500	24,2
FT 150/A530 2V R	530	84	14500	9000	11000	26
FT 150/A560 2V R	560	97	16000	10000	12500	27
FT 150/A625 2V R	625	84	21500	12500	16000	29
FT 150/A650 2V R	650	97	23500	14000	18000	30
FT 150/A715 2V R	715	84		17500	22000	31,5
FT 150/A790 2V R	790	97		21000	27000	33
FT 150/A920 2V R	920	126		29000		70

10



## AVVOLGITUBI IDRAULICI A 3 VIE CON ATTACCO RADIALE DEI TUBI 3 WAY HYDRAULIC HOSE REELS WITH RADIAL ATTACHMENT

In conformità EN 2006/42/CE  
According to EN 2006 42 EC

### FT 170/A 3V R EYE

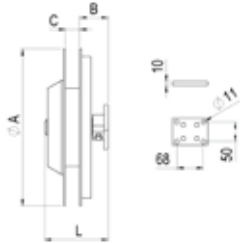

	Ø 1/4"	Ø 1/2"	Ø 3/8"
C	40		54
L	200		210

Modello Model	A Ø mm	B mm	Lungh. max avvolg. (mm) e connessioni Max reel length (mm) and connections			Peso Weight kg
			Ø 1/4"	Ø 1/2"	Ø 3/8"	
FT 170/A200 3V R EYE	200	87	1500			15
FT 170/A270 3V R EYE	270	87	2500		1800	16
FT 170/A300 3V R EYE	300	87	4000		2700	16,5
FT 170/A325 3V R EYE	325	87	5000		3500	17,5
FT 170/A235 3V R EYE	235	87	2000			6
FT 170/A340 3V R EYE	340	87	5200		4000	12,5
FT 170/A385 3V R EYE	385	87	7000		5500	18,5

Per tubi con raccordo ad occhio e rondelle "bonded-seals"  
For hoses with eye-fitting and "bonded-seals" washers

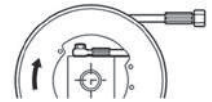

### FT 175/A 3V R

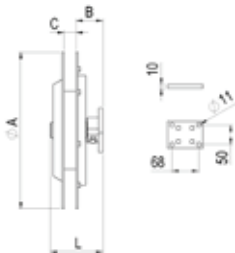

	Ø 1/4"	Ø 1/2"	Ø 3/8"
C	40		
L	157		

Modello Model	A Ø mm	B mm	Lungh. max avvolg. (mm) e connessioni Max reel length (mm) and connections			Peso Weight kg
			Ø 1/4"	Ø 1/2"	Ø 3/8"	
FT 175/A325 3V R	325	73	4000			14
FT 175/A370 3V R	370	73	5500			15
FT 175/A385 3V R	385	73	6000			16
FT 175/A400 3V R	400	73	7200			16,5
FT 175/A420 3V R	420	73	8400			17,5
FT 175/A470 3V R	470	73	11000			18,5
FT 175/A500 3V R	500	73	12500			21,5

### FT 170/A 3V R

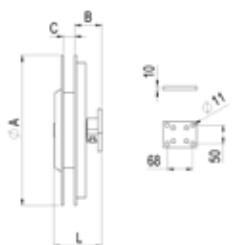

	Ø 1/4"	Ø 1/2"	Ø 3/8"
C		66	54
L		240	216

Modello Model	A Ø mm	B mm	Lungh. max avvolg. (mm) e connessioni Max reel length (mm) and connections			Peso Weight kg
			Ø 1/4"	Ø 1/2"	Ø 3/8"	
FT 170/A325 3V R	325	110		2500	3000	20
FT 170/A385 3V R	385	110		3500	5000	22
FT 170/A400 3V R	400	110		4500	6000	23
FT 170/A420 3V R	420	110		5500	6500	23,4
FT 170/A470 3V R	470	110		6500	8000	25
FT 170/A500 3V R	500	110		8000	10000	30
FT 170/A520 3V R	520	110		8500	10500	30,5
FT 170/A530 3V R	530	110		9000	11000	31
FT 170/A560 3V R	560	110		10000	12500	37
FT 170/A625 3V R	625	110		12500	16000	41
FT 170/A650 3V R	650	110		14000	18000	45
FT 170/A715 3V R	715	110		17500	22000	47
FT 170/A790 3V R	790	110		21000	26000	50,5



## AVVOLGITUBI IDRAULICI A 4 VIE CON ATTACCO RADIALE DEI TUBI 4 WAY HYDRAULIC HOSE REELS WITH RADIAL ATTACHMENT

In conformità EN 2006/42/CE  
According to EN 2006 42 EC

### FT 180/A 4V EYE

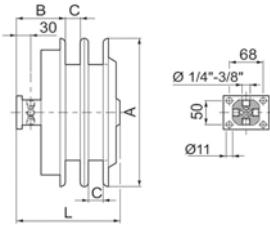

	Ø 1/4"	Ø 1/2"	Ø 3/8"
C	27		36
L	189		220

Modello Model	A B		Lungh. max avvolg. (mm) e connessioni Max reel length (mm) and connections			Peso Weight
	Ø mm	mm	Ø 1/4"	Ø 1/2"	Ø 3/8"	kg
FT 180/A200 4V R EYE	200	86	1500			8,5
FT 180/A270 4V R EYE	270	86	2500		1800	12,6
FT 180/A300 4V R EYE	300	86	4000		2700	14,5
FT 180/A325 4V R EYE	325	86	5000		3500	15
FT 180/A385 4V R EYE	385	86	7000		5500	16,5
FT 180/A235 4V R EYE	235	86	2000			6
FT 180/A340 4V R EYE	340	86	5200		4000	18

Per tubi con raccordo ad occhio e rondelle "bonded-seals"  
For hoses with eye-fitting and "bonded-seals" washers

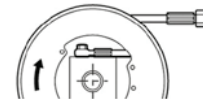

### FT 180/A 4V R

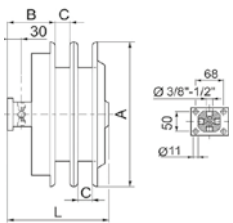

	Ø 1/4"	Ø 1/2"	Ø 3/8"
C		46	36
L		261	251

Modello Model	A B		Lungh. max avvolg. (mm) e connessioni Max reel length (mm) and connections			Peso Weight
	Ø mm	mm	Ø 1/4"	Ø 1/2"	Ø 3/8"	kg
FT 180/A325 4V R	325	110		2500	3000	20(3/8") 22(1/2")
FT 180/A370 4V R	370	110		3300	4500	21(3/8") 23(1/2")
FT 180/A385 4V R	385	110		3500	5000	22(3/8") 24(1/2")
FT 180/A400 4V R	400	110		4500	5500	22,5(3/8") 24,5(1/2")
FT 180/A420 4V R	420	110		5500	6500	23(3/8") 25,5(1/2")
FT 180/A470 4V R	470	110		6500	8000	24,5(3/8") 27,5(1/2")
FT 180/A500 4V R	500	110		8000	10000	31(3/8") 34(1/2")
FT 180/A520 4V R	520	110		8500	10500	31,5(3/8") 35(1/2")
FT 180/A530 4V R	530	110		9000	11000	32(3/8") 36(1/2")
FT 180/A560 4V R	560	110		10000	12500	38(3/8") 41(1/2")
FT 180/A625 4V R	625	110		12500	16000	41(3/8") 45(1/2")
FT 180/A650 4V R	650	110		14000	18000	42(3/8") 47(1/2")
FT 180/A715 4V R	715	110		17500	22000	43(3/8") 48(1/2")
FT 180/A790 4V R	790	110		21000	27000	44(3/8") 49(1/2")

### FT 190/A 4V R CI

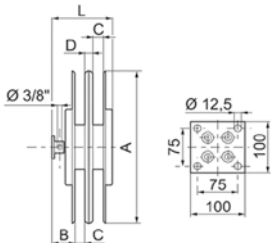

	Ø 1/4"	Ø 1/2"	Ø 3/8"
C	27		36
D	74		56
L	260		260

Modello Model	A B		Lungh. max avvolg. (mm) e connessioni Max reel length (mm) and connections			Peso Weight
	Ø mm	mm	Ø 1/4"	Ø 1/2"	Ø 3/8"	kg
FT 190/A325 4V R CI	325	100	4000		3000	25
FT 190/A385 4V R CI	385	100	6000		5000	27
FT 190/A400 4V R CI	400	100	7200		5500	28
FT 190/A420 4V R CI	420	100	8500		6500	29
FT 190/A470 4V R CI	470	100	11000		8000	30,5
FT 190/A500 4V R CI	500	97			10000	47
FT 190/A530 4V R CI	530	97			11000	49
FT 190/A560 4V R CI	560	97			12500	50
FT 190/A625 4V R CI	625	97			16000	54
FT 190/A650 4V R CI	650	97			18000	49,5
FT 190/A715 4V R CI	715	97			22000	59

Modello con CORPI INDIPENDENTI = 2 corpi e 2 molle indipendenti su unico albero  
Model with INDEPENDENT CASINGS = 2 casings and 2 independent springs on a single shaft



## AVVOLGITUBI IDRAULICI A 5 VIE CON ATTACCO RADIALE DEI TUBI 5 WAY HYDRAULIC HOSE REELS WITH RADIAL ATTACHMENT

In conformità EN 2006/42/CE  
According to EN 2006 42 EC

### FT 210/A 5V R

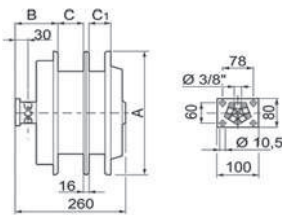

Ø 3/8"	
C	54
C1	36

Modello Model	A Ø mm	B mm	Lungh. max avvolg. (mm) e connessioni Max reel length (mm) and connections			Peso Weight kg
			Ø 1/4"	Ø 1/2"	Ø 3/8"	
FT 210/A325 5V R	325	110			3000	23
FT 210/A385 5V R	385	110			5000	26
FT 210/A400 5V R	400	110			5500	26,5
FT 210/A420 5V R	420	110			6500	27,5
FT 210/A470 5V R	470	110			8000	30
FT 210/A500 5V R	500	110			10000	37
FT 210/A530 5V R	530	110			11000	39
FT 210/A560 5V R	560	110			12500	45
FT 210/A625 5V R	625	110			16000	50

### FT 220/A 5V R CI

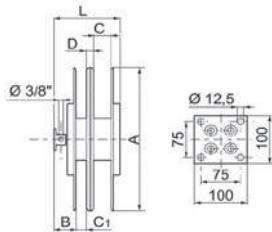

Ø 3/8"	
C	54
C1	36
L	310

Modello Model	A Ø mm	B mm	Lungh. max avvolg. (mm) e connessioni Max reel length (mm) and connections			Peso Weight kg
			Ø 1/4"	Ø 1/2"	Ø 3/8"	
FT 220/A470 5V R CI	470	110			8000	60
FT 220/A500 5V R CI	500	110			10000	66
FT 220/A530 5V R CI	530	110			11000	67,5
FT 220/A560 5V R CI	560	110			12500	70
FT 220/A625 5V R CI	625	110			16000	74
FT 220/A650 5V R CI	650	110			22000	76,5
FT 220/A715 5V R CI	715	110			27000	81
FT 220/A790 5V R CI	790	110			18000	89

Modello con CORPI INDIPENDENTI = 2 corpi e 2 molle indipendenti su unico albero  
Model with INDEPENDENT CASINGS = 2 casings and 2 independent springs on a single shaft

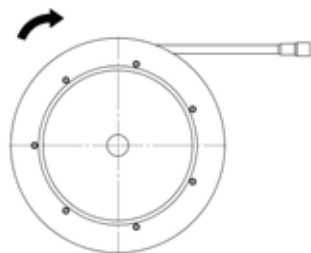

Senso orario - Clock wise

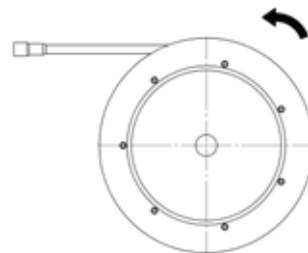

Senso antiorario - Anti clock wise

Specificare al momento ordine senso di rotazione  
At the time of the order specify rotation direction





## AVVOLGITUBI ELETTROIDRAULICI A 2 VIE CON ATTACCO RADIALE DEI TUBI 2 WAY ELECTRO-HYDRAULIC HOSE REELS WITH RADIAL ATTACHMENT

In conformità EN 2006/42/CE  
According to EN 2006 42 EC

### FT 320/A 2V EYE

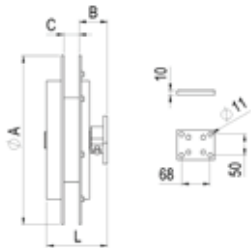

Modello Model	A Ø mm	B mm	Lungh. max avvolg. (mm) e connessioni Max reel length (mm) and connections			Peso Weight kg	Contatti N° Contacts 3÷7 Ampere
			Ø 1/4"	Ø 1/2"	Ø 3/8"		
FT 320E/A325 2V R	325	86	4000*	2500	3000	17,8	2÷12
FT 320E/A385 2V R	385	86	6000*	3500	5000	20,2	2÷12
FT 320E/A400 2V R	400	86	7200*	4500	5500	21	2÷12
FT 320E/A420 2V R	420	86	8400*	5500	6500	22,2	2÷12
FT 320E/A470 2V R	470	86	11000*	6500	8000	23,8	2÷12

	Ø 1/4"	Ø 1/2"	Ø 3/8"
C	40	66	54
L	180	190	190
Lmax	300	300	300

### FT 330/A 2V EYE

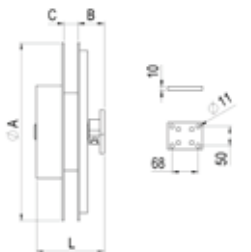

Modello Model	A Ø mm	B mm	Lungh. max avvolg. (mm) e connessioni Max reel length (mm) and connections			Peso Weight kg	Contatti N° Contacts 3÷7 Ampere
			Ø 1/4"	Ø 1/2"	Ø 3/8"		
FT 330RE/A470 2V R	470	97	11000*	6500	8000	31	2÷12
FT 330RE/A500 2V R	500	97	12500*	8000	10000	33,3	2÷12
FT 330RE/A530 2V R	530	97	14500*	9000	11000	35	2÷12
FT 330RE/A560 2V R	560	97	16000*	10000	12500	37,3	2÷12
FT 330RE/A625 2V R	625	97	21500*	12500	16000	41,4	2÷12
FT 330RE/A715 2V R	715	97		17500	22000	47,7	2÷12
FT 330RE/A790 2V R	790	97		21000	27000	50	2÷12

	Ø 1/4"	Ø 1/2"	Ø 3/8"
C	40	66	54
L	190	200	200
Lmax	318	325	325

\* Per Tubi con Ø 1/4" - 3÷7 Ampere - massimo contatti 2÷5  
\* For hoses with 1/4" - 3÷7 Ampere - contacts max 2÷5

10



### INFORMAZIONI NECESSARIE PER FINALIZZARE LOFFERTA INFORMATION NECESSARY TO FINALIZE THE OFFER:

- Diametro tubo (3/8"-1/2" ecc.) / Hose Diameter (3/8"-1/2" ecc.)
- Lunghezza tubo (mm) / Hose length (mm)
- Pressione di Esercizio (bar) / Working pressure (bar)
- Numero di contatti / Number of contacts
- Assorbimento (Ampère) / Assorbition (Ampère)
- Voltaggio (12 o 24V) / Volts (12 o 24 V)

